

Pitch:1.27x1.27mm(0.05 " x0.05 ")
 Box Header Right Angle Dip Type

ELETE
 Professional Connecting Solutions
 BXIDR01 Series

Specifications

Current Rating:1.0 Ampere
 Insulation Resistance:1000MΩ Min
 Dielectric Withstanding:300V AC
 Contact Resistance:20mΩ Max
 Operating Temperature:-40°C to +105°C

Materials

Contact Material: Brass
 Insulation Material: Polyester,UL 94V-0
 LCP/NL6T
 All material RoHS&Reach Compliant
 Halogen-free is available

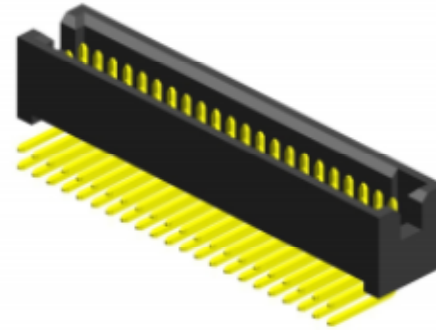

Mating with

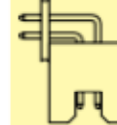

HFIDSXX



HFIDMXX

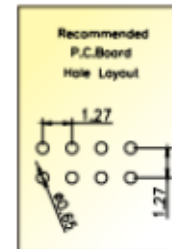
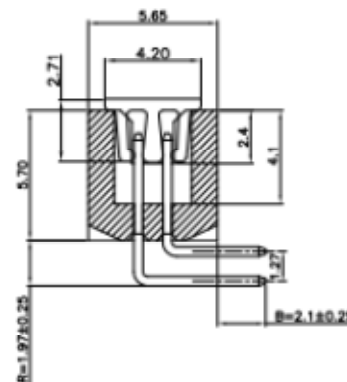
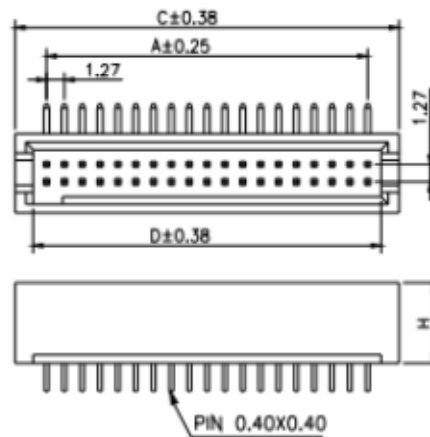

No. of Pins/Row	Dimension Information			No. of Pins/Row	Dimension Information			No. of Pins/Row	Dimension Information			No. of Pins/Row	Dimension Information		
	A	C	D		A	C	D		A	C	D		A	C	D
03	2.51	7.01	5.69	17	20.32	24.79	23.47	31	38.10	42.57	41.25	45	55.88	60.35	59.03
04	3.78	8.28	6.96	18	21.59	26.06	24.74	32	39.37	43.84	42.52	46	57.15	61.62	60.30
05	5.08	9.55	8.23	19	22.86	27.33	26.01	33	40.64	45.11	43.79	47	58.42	62.89	61.57
06	6.35	10.82	9.50	20	24.13	28.60	27.28	34	41.91	46.38	45.06	48	59.69	64.16	62.84
07	7.62	12.09	10.77	21	25.40	29.87	28.55	35	43.18	47.65	46.33	49	60.96	65.43	64.11
08	8.89	13.36	12.04	22	26.67	31.14	29.82	36	44.45	48.92	47.60	50	62.23	66.70	65.38
09	10.16	14.63	13.31	23	27.94	32.41	31.09	37	45.72	50.19	48.87				
10	11.43	15.9	14.58	24	29.21	33.68	32.36	38	46.99	51.46	50.14				
11	12.70	17.17	15.85	25	30.48	34.95	33.63	39	48.26	52.73	51.41				
12	13.97	18.44	17.12	26	31.75	36.22	34.90	40	49.53	54.00	52.68				
13	15.24	19.71	18.39	27	33.02	37.49	36.17	41	50.80	55.27	53.95				
14	16.51	20.98	19.66	28	34.29	38.76	37.44	42	52.07	56.54	55.22				
15	17.78	22.25	20.93	29	35.56	40.03	38.71	43	53.34	57.81	56.49				
16	19.05	23.52	22.20	30	36.83	41.30	39.98	44	54.61	59.08	57.76				