

1	2	3	4	5	6	7
A	B	C	D	E	F	G
A	B	C	D	E	F	G
B	C	D	E	F	G	H
C	D	E	F	G	H	H
D	E	F	G	H	H	H
E	F	G	H	H	H	H
F	G	H	H	H	H	H
G	H	H	H	H	H	H
H	H	H	H	H	H	H

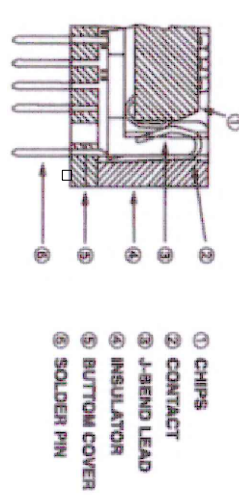
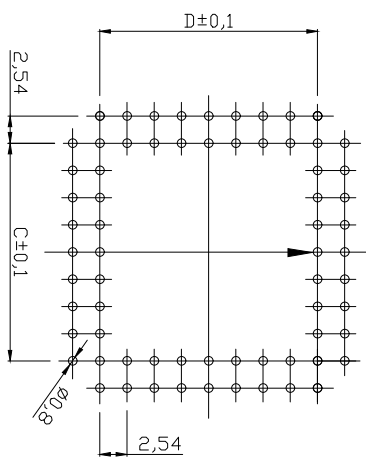
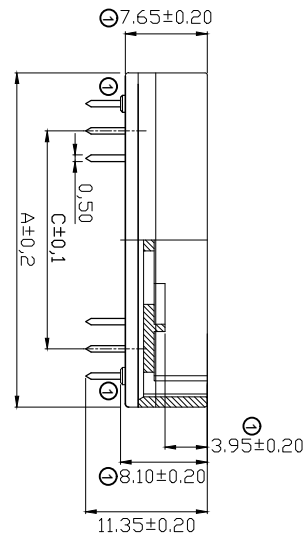
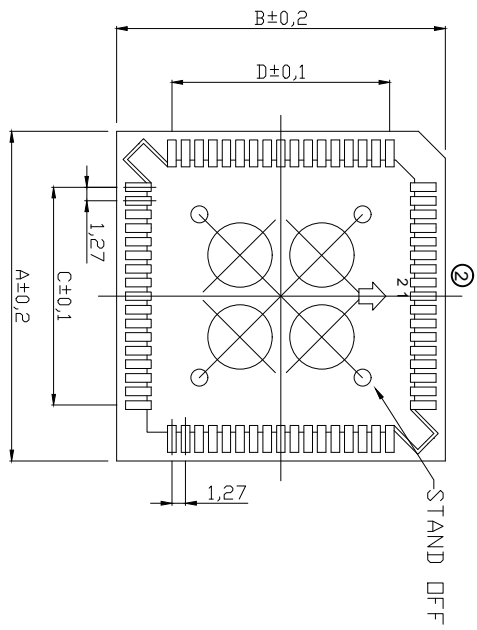

Dimensions

No. of Contacts	Insulator	A±0.2	B±0.2	C±0.1	D±0.1
20	PBT, Black, UL94V-0	15.50	15.50	5.08	5.08
28	PBT, Black, UL94V-0	18.05	18.05	7.62	7.62
32	PBT, Black, UL94V-0	18.05	20.60	7.62	10.16
44	PBT, Black, UL94V-0	23.50	23.50	12.70	12.70
52	PBT, Black, UL94V-0	25.88	25.88	15.24	15.24
68	PPS, Black, UL94V-0	31.05	31.05	20.32	20.32
84	PPS, Black, UL94V-0	36.05	36.05	25.40	25.40

Product Specification

Material
 Insulator: Glass filled PBT or PPS UL94V-0 Black
 Contact: Phosphor Bronze, 0.25mm Thickness
 Plated: 0.8u" Gold on contact area, 0.2-0.3u" Gold on other area
 80-120u" Tin on solder area, all over 30-50u" Nickel

MECHANICAL PERFORMANCE:
 Durability: Per MIL-STD-1344, Method 2016.25 Cycles
 Vibration: Per MIL-STD-810C, Method 514.2 10-200.000Hz 5G's
 Shock: Per MIL-STD-810C, Method 516.2.35G's
 Acceleration: Per MIL-STD-810C, Method 513.2, 15G's
 Contact Force: 170g/per pin.

ELECTRICAL PERFORMANCE:
 Contact Interface Resistance:
 Initial: 6.5 Milliohms Average
 Final: 15.0 Milliohms Average Max. After Testing
 Insulation Resistance: 10000 Megohms min.
 Dielectric Strength: 1000V/AC continuous for 1 minute.
 Capacitance: Less Than 1.0pF At 1000KHz.
 Operating and Storage Temperature: -40°C to +105°C

Packing: Tube

RoHS compliant
 Unit: mm

Scale	Free
TOLERANCE	
X.	±X
X.X	±X
X.XX	±X
X.°	±X
Angle	TOL

Id.	Modification	Date	Name
①	Update the plating spec	11.05.2018	Segal
②	Add Pin out Diagrams	02.08.2018	Xavier
③	Drawn	29.09.2015	Amy

Date	Name
29.09.2015	Amy
29.09.2015	Amy

Customer-No.	ASSMANN WSW-No.	Drawing-No.	ASS 7007 CO	rev02
	A-CCS 0XX-G-T			Sheet 1/2



	1	2	3	4	5	6	7																																																																	
A	② PCB Layout & Pin-out Diagram							A																																																																
B								B																																																																
C								C																																																																
D								D																																																																
E								E																																																																
F								F																																																																
G	<p style="text-align: center;">RoHS compliant Unit: mm</p> <table border="1"> <thead> <tr> <th>Scale</th> <th>Free</th> <th></th> <th></th> <th></th> <th></th> <th></th> <th>Customer-No.</th> </tr> </thead> <tbody> <tr> <td colspan="8">TOLERANCE</td> </tr> <tr> <td>X.</td> <td>±X</td> <td></td> <td></td> <td></td> <td></td> <td></td> <td></td> </tr> <tr> <td>X.X</td> <td>±X</td> <td></td> <td></td> <td></td> <td></td> <td></td> <td></td> </tr> <tr> <td>X.XX</td> <td>±X</td> <td>②</td> <td>Add Pin out Diagrams</td> <td>02.08.2018</td> <td>Xavier</td> <td></td> <td>ASSMANN WSW-No. A-CCS 0XX-G-T</td> </tr> <tr> <td>X.°</td> <td>±X</td> <td>①</td> <td>Update the plating spec</td> <td>11.05.2018</td> <td>Segal</td> <td></td> <td>Drawing-No. ASS 7007 CO</td> </tr> <tr> <td>Angle</td> <td>TOL</td> <td>③</td> <td>Drawn</td> <td>29.09.2015</td> <td>Amy</td> <td></td> <td>Replace rev02</td> </tr> <tr> <td></td> <td></td> <td></td> <td>Modification</td> <td>Date</td> <td>Name</td> <td></td> <td>Sheet 2/2</td> </tr> </tbody> </table>							Scale	Free						Customer-No.	TOLERANCE								X.	±X							X.X	±X							X.XX	±X	②	Add Pin out Diagrams	02.08.2018	Xavier		ASSMANN WSW-No. A-CCS 0XX-G-T	X.°	±X	①	Update the plating spec	11.05.2018	Segal		Drawing-No. ASS 7007 CO	Angle	TOL	③	Drawn	29.09.2015	Amy		Replace rev02				Modification	Date	Name		Sheet 2/2	G
Scale	Free						Customer-No.																																																																	
TOLERANCE																																																																								
X.	±X																																																																							
X.X	±X																																																																							
X.XX	±X	②	Add Pin out Diagrams	02.08.2018	Xavier		ASSMANN WSW-No. A-CCS 0XX-G-T																																																																	
X.°	±X	①	Update the plating spec	11.05.2018	Segal		Drawing-No. ASS 7007 CO																																																																	
Angle	TOL	③	Drawn	29.09.2015	Amy		Replace rev02																																																																	
			Modification	Date	Name		Sheet 2/2																																																																	
H	1	2	3	4	5	6	7	H																																																																