

**Ordering Information:**

A2508WV-F-2xXP -  $\frac{*}{1}$  -  $\frac{***}{2}$  -  $\frac{**}{3}$  -  $\frac{**}{4}$

1.Part NO.

2.Pin Finish:

(Blank): Tin over Nickel

G: Gold over Nickel

3.Size(D):

(Blank): 3.50±0.20

D30: 3.00±0.20

4.Logo:

(Blank): With CJT Logo

NK: Without CJT Logo

**SPECIFICATIONS:**

Current Rating: 3A AC,DC

Voltage Rating: 250V AC,DC

Temperature Range: -25°C ~ +85°C

Contact Resistance: 20mΩ Max.

Insulation Resistance: 1000MΩ Min.

Withstanding Voltage: 1000V AC/minute

Pin Material: Brass

Material: Glass-filled Nylon 66,UL94V-0(Natural)

**Ordering Information & Dimensions**

Part NO.	Dimensions(mm)	
	A	B
A2508WV-F-2x4P	7.50	15.00
A2508WV-F-2x5P	10.00	17.50
A2508WV-F-2x6P	12.50	20.00
A2508WV-F-2x7P	15.00	22.50
A2508WV-F-2x8P	17.50	25.00
A2508WV-F-2x9P	20.00	27.50
A2508WV-F-2x10P	22.50	30.00
A2508WV-F-2x11P	25.00	32.50
A2508WV-F-2x12P	27.50	35.00
A2508WV-F-2x13P	30.00	37.50
A2508WV-F-2x14P	32.50	40.00
A2508WV-F-2x15P	35.00	42.50
A2508WV-F-2x16P	37.50	45.00
A2508WV-F-2x17P	40.00	47.50
A2508WV-F-2x18P	42.50	50.00
A2508WV-F-2x19P	45.00	52.50
A2508WV-F-2x20P	47.50	55.00

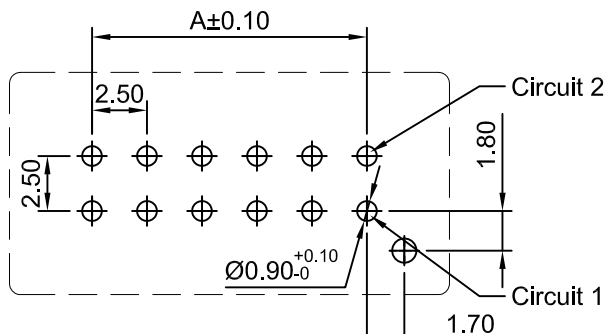
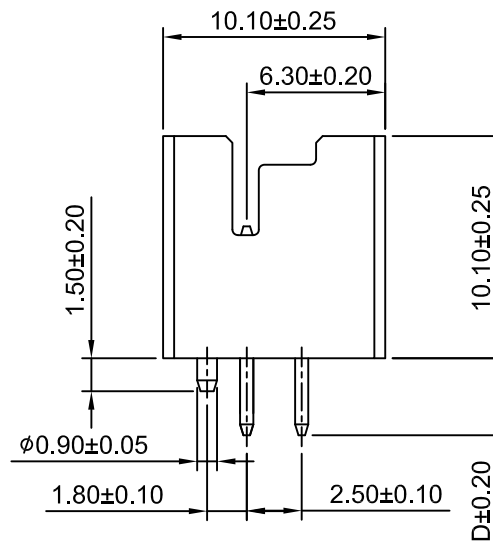
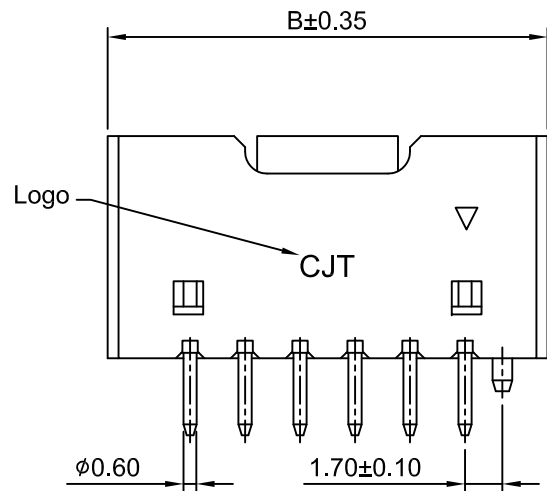

**P.C.B LAYOUT (TOP VIEW)**  
TOLERANCE:±0.05

**CJT** CHANGJIANG CONNECTORS CO.,LTD.

Unit	Scale	Sheet
mm	3:1	1 of 1
DRAWN	CHK'D	APPR
Dengchun Yi	Diankui Wan	Jack Yin
General Tolerances		THIRD ANGLE PROJECTION
x.xx±0.25		
x.xxx±0.20		
x.xxxx±0.15		
ANGLES ±1°		

TITLE	
2.50mm PITCH VERTICAL DUAL ROW DIP WAFER	
DRAWING NO.	REV
A2508WV-F-2xXP	A4

REV	DESCRIPTION	DATE
A4	CHANGE THE INFORMATION	2022.11.03
A3	MODIFY DRAWING	2022.09.06
A2	CHANGE THE INFORMATION	2021.05.13
A1	CHANGE THE DRAWING	2020.05.13
A0	NEW RELEASE	2018.09.30