



Plug-in socket for RT relay Standard plug-in socket screw terminal

General technical data	
display version LED	No
protection class IP	IP20
reference code according to IEC 81346-2	U
Substance Prohibitance (Date)	05/01/2012
Mechanical data	
product component plug-in socket	Yes
design of the snap-on socket base	Standard socket
design of the relay operating mechanism	poled
Auxiliary circuit	
number of NC contacts for auxiliary contacts	0
number of NO contacts for auxiliary contacts	0
number of CO contacts for auxiliary contacts	0
Connections/ Terminals	
product function removable terminal	No
type of electrical connection	screw terminal
type of connectable conductor cross-sections	
<ul style="list-style-type: none"> <li>• solid</li> <li>• finely stranded with core end processing</li> <li>• for AWG cables solid</li> </ul>	1x (1,0 ... 2,5), 2x 1,0, 2x 1,5, 2x 2,5 1x (1,0 ... 1,5), 2x 1,0, 2x 1,5 1x (18 ... 14), 2x 18, 2x 16, 2x 14
connectable conductor cross-section	
<ul style="list-style-type: none"> <li>• solid</li> <li>• finely stranded with core end processing</li> </ul>	1 ... 2.5 mm <sup>2</sup> 1 ... 1.5 mm <sup>2</sup>
AWG number as coded connectable conductor cross section	
<ul style="list-style-type: none"> <li>• solid</li> </ul>	18 ... 14
tightening torque with screw-type terminals	0.5 ... 0.7 N·m
Installation/ mounting/ dimensions	
mounting position	any
fastening method	snap-on mounting
height	78 mm
width	15.5 mm
depth	42.3 mm
required spacing	
<ul style="list-style-type: none"> <li>• with side-by-side mounting                             <ul style="list-style-type: none"> <li>— forwards</li> <li>— backwards</li> <li>— upwards</li> <li>— downwards</li> <li>— at the side</li> </ul> </li> </ul>	0 mm 0 mm 0 mm 0 mm 0 mm

- for grounded parts
  - forwards 0 mm
  - backwards 0 mm
  - upwards 0 mm
  - at the side 0 mm
  - downwards 0 mm
- for live parts
  - forwards 0 mm
  - backwards 0 mm
  - upwards 0 mm
  - downwards 0 mm
  - at the side 0 mm

0 mm
0 mm
0 mm
0 mm
0 mm
0 mm
0 mm
0 mm
0 mm
0 mm
0 mm

**Ambient conditions**

<b>ambient temperature</b>	
• during operation	-40 ... +70 °C
• during storage	-20 ... +70 °C
• during transport	-20 ... +70 °C

**Approvals Certificates**

<b>General Product Approval</b>	<b>other</b>	<b>Environment</b>
---------------------------------	--------------	--------------------

[Confirmation](#)



[Confirmation](#)

[Environmental Confirmations](#)

**Further information**

- Information on the packaging  
<https://support.industry.siemens.com/cs/ww/en/view/109813875>
- Information- and Downloadcenter (Catalogs, Brochures,...)  
<https://www.siemens.com/ic10>
- Industry Mall (Online ordering system)  
<https://mall.industry.siemens.com/mall/en/en/Catalog/product?mlfb=LZS:RT78725>
- Cax online generator  
<http://support.automation.siemens.com/WW/CAXorder/default.aspx?lang=en&mlfb=LZS:RT78725>
- Service&Support (Manuals, Certificates, Characteristics, FAQs,...)  
<https://support.industry.siemens.com/cs/ww/en/ps/LZS:RT78725>
- Image database (product images, 2D dimension drawings, 3D models, device circuit diagrams, EPLAN macros, ...)  
[http://www.automation.siemens.com/bilddb/cax\\_de.aspx?mlfb=LZS:RT78725&lang=en](http://www.automation.siemens.com/bilddb/cax_de.aspx?mlfb=LZS:RT78725&lang=en)
- Characteristic: Derating  
<https://support.industry.siemens.com/cs/ww/en/ps/LZS:RT78725/manual>

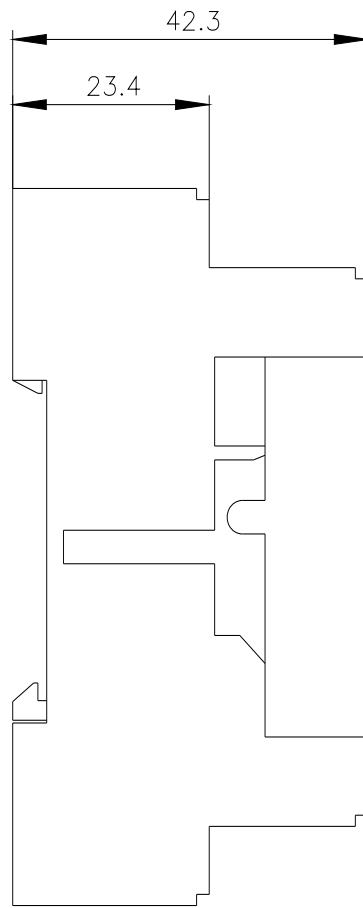
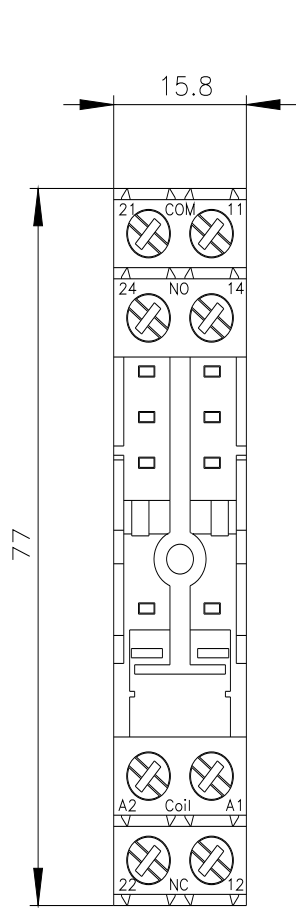



NSB0\_01762a

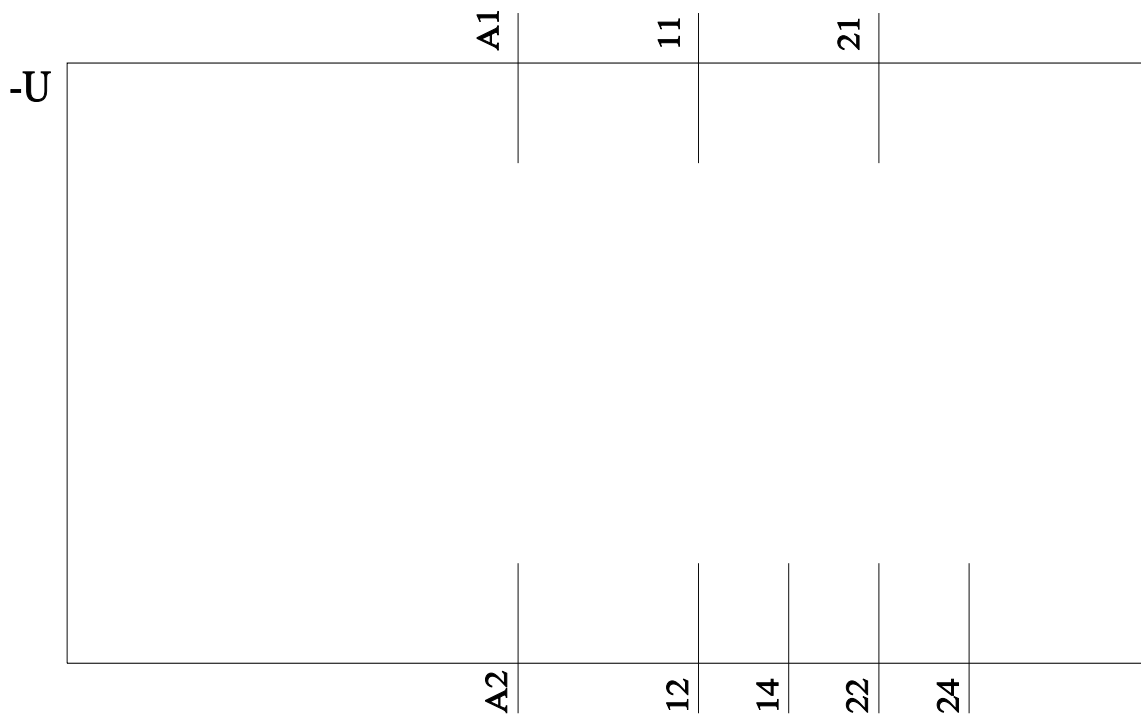

---

last modified:

4/8/2024 