

POWER CONNECTION SYSTEMS CRIMP CONTACTS

Contacts are not supplied with connectors and must be ordered separately

FEMALE CONTACT ("CLOSED ENTRY" DESIGN)

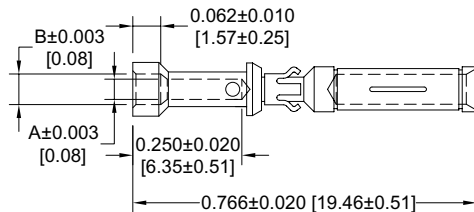

PART NUMBERS	WIRE SIZE AWG/[mm ²]	A	B
FC112N2	12 [4.0]	0.098 [2.49]	
FC114N2	14-16 [2.5-1.5]	0.081 [2.06]	0.105 [2.67]
FC116N2	16-18 [1.5-1.0]	0.067 [1.70]	0.093 [2.36]
FC120N2	20-22-24 [0.5-0.3-0.25]	0.045 [1.14]	0.065 [1.65]

MALE CONTACT

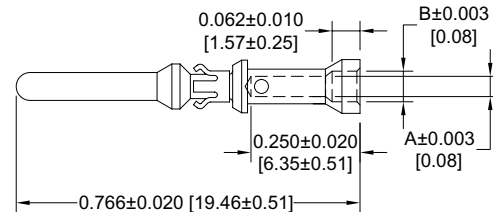

PART NUMBERS	WIRE SIZE AWG/[mm ²]	A	B	CØ
MC112N	12 [4.0]	0.098 [2.49]		0.0625 [1.588]
MC114N	14-16 [2.5-1.5]	0.081 [2.06]	0.105 [2.67]	0.0625 [1.588]
MC116N	16-18 [1.5-1.0]	0.067 [1.70]	0.093 [2.36]	0.0625 [1.588]
MC120N	20-22-24 [0.5-0.3-0.25]	0.045 [1.14]	0.065 [1.65]	0.0625 [1.588]

Material: Copper alloy.

Finish: Gold flash over nickel. 0.000030 [0.75µ] gold over nickel available by adding -14 suffix onto part number. Example: FC120N2-14.

POWER CONNECTION SYSTEMS "HIGH CONDUCTIVITY" CRIMP CONTACTS

Contacts are not supplied with connectors and must be ordered separately

FEMALE CONTACT ["CLOSED ENTRY" DESIGN]

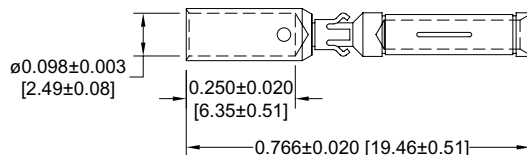

PART NUMBERS	WIRE SIZE AWG/[mm ²]	A	B
FC112N2S	12 [4.0]	0.098 [2.49]	

MALE CONTACT

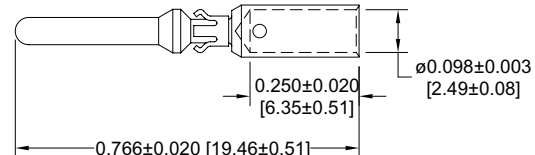

PART NUMBERS	WIRE SIZE AWG/[mm ²]	A	B	CØ
MC112NS	12 [4.0]	0.098 [2.49]		0.0625 [1.588]

Material: High conductivity tellurium copper.

Finish: gold flash over nickel. 0.000030 [0.75µ] gold over nickel available by adding -14 suffix onto part number.

Example: FC112N2S-14

Wire size: 12 AWG [4.0mm²]

DIMENSIONS ARE IN INCHES [MILLIMETERS].
ALL DIMENSIONS ARE SUBJECT TO CHANGE.