

GT-B0803 F S V XX -XX X XX 01

- G-Switch**
- Series No**
- F-Female**
- Termpoint**  
S-SMT
- Angle**  
V-180°
- Terminal Plating**  
04-Au10u"
- Housing Colour**  
B-Black
- Pin Q' PY**  
10-200
- Height**  
50-5.10mm  
70-7.00mm  
90-9.00mm

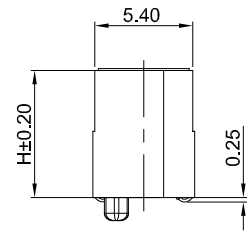
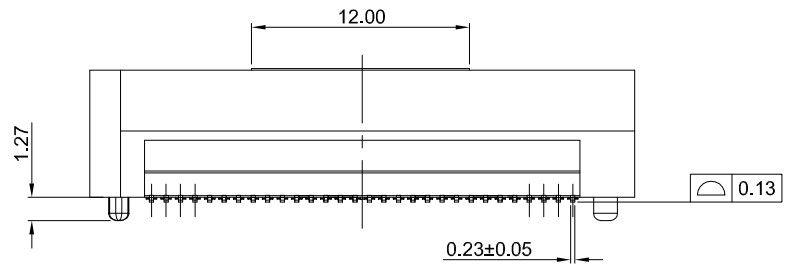

**G-Switch Specification:**

1. Current rated: 1.4A AC/DC
2. Voltage rating: 225V AC/DC
3. Withstanding voltage: 675V AC
4. Contact resistance: 15mΩ Max.
5. Insulation resistance: 5000MΩ min
6. Durability cycle: 30 Cycles
7. Removal force: 0.01kgf/Pin min
8. Operating temperature range: -55°C ~ +125°C

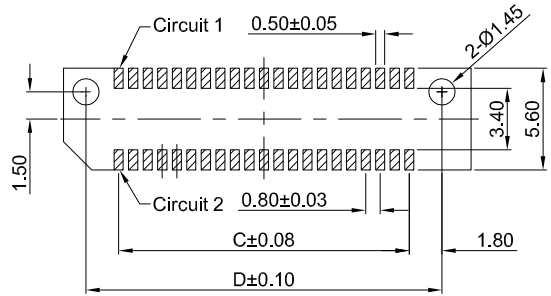
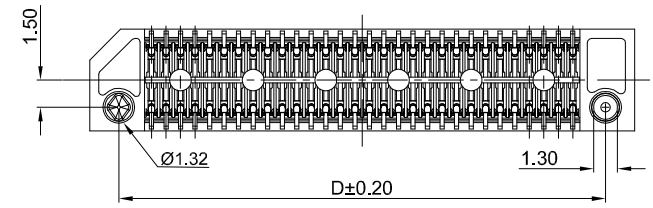

RECOMMEND PCB LAYOUT  
TOLERANCE:±0.05

**Ordering Information:**

Circuit	Dimensions(mm)			
	A	B	C	D
10	10.00	8.32	3.20	6.80
20	14.00	12.32	7.20	10.80
22	14.80	13.12	8.00	11.60
24	15.60	13.92	8.80	12.40
26	16.40	14.72	9.60	13.20
30	18.00	16.32	11.20	14.80
40	22.00	20.32	15.20	18.80
50	26.00	24.32	19.20	22.80
60	30.00	28.32	23.20	26.80
70	34.00	32.32	27.20	30.80
80	38.00	36.32	31.20	34.80
100	46.00	44.32	39.20	42.80
120	54.00	52.32	47.20	50.80
140	62.00	60.32	55.20	58.80
150	66.00	64.32	59.20	62.80
200	86.00	84.32	79.20	82.00

Height	H(mm)
5.00	5.10
7.00	7.00
9.00	9.00

Mate(H)	Mated height(mm)			
	Femate(H)			
2.0	5.00	7.00	9.00	11.00
3.0	8.00	--	--	--
5.0	10.00	12.00	14.00	--
8.0	13.00	15.00	17.00	--
9.0	14.00	16.00	18.00	--

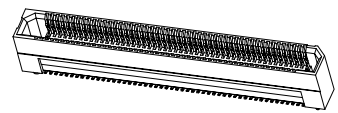

NO.	PART NAME	MATERIAL	REMARK
2	CONTACT	PHOSPHOR BRONZE	Au10u" ON CONTACT AREA
1	HOUSING	LCP,94V-0	BLACK

SCALE: 1:1	UNIT: mm	Title: BTB 0.80mm Pitch 180° Dual Rows SMT Type Femate Connector	
SIZE: A4			
Unless otherwise General Tolerance:		Molde Code: GT-B0803FSVXX-XXXXX01	
X	±0.40		
X.x	±0.30		
X.xx	±0.20		
X°	±5°		
X.x°	±3°		
DRAWN	CHECKED	APPROVED	DATE
Hu	Chen	Chen	2022.12.28



REV: A0 SHEET: 1/1