

A 编码

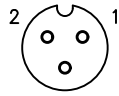

2Pin



3Pin

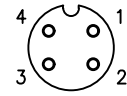

4Pin

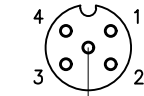

5Pin

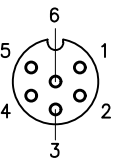

6Pin

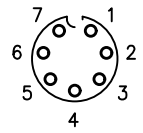

7Pin

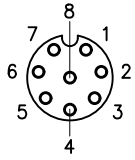

8Pin

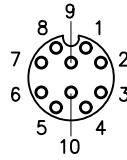

10Pin

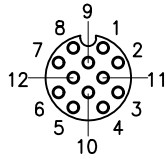

12Pin

B 编码

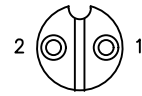

2Pin B

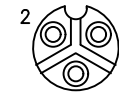

3Pin B

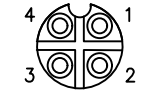

4Pin B

C 编码

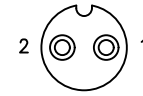

2Pin C

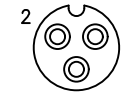

3Pin C

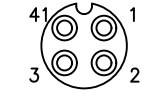

4Pin C

芯数

2P

3P

4P

5P

6P

7P

8P

10P

12P

2P B

3P B

4P B

2P C

3P C

4P C

额定电压

60V

60V

60V

60V

60V

60V

60V

30V

30V

300V

300V

300V

125V

125V

125V

额定电流

5A

5A

5A

5A

5A

5A

5A

2A

2A

10A

10A

10A

10A

10A

10A

防水等级

IP67/IP68

使用温度

-45°C~105°C

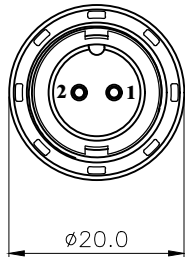
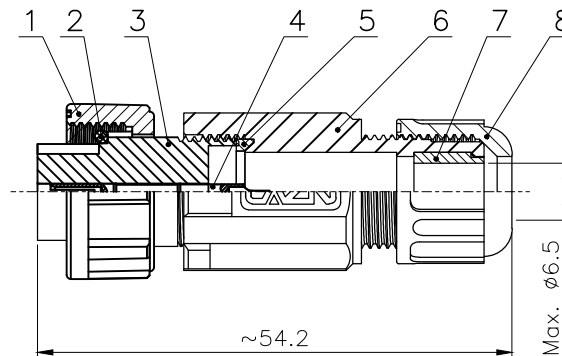
 $\phi 20.0$ 

 $\sim 54.2$ 
 $\text{Max. } \phi 6.5$ 

E系列 插针:

2~12P: E系列 1.0焊线式母针长针

2~4P B: E系列 1.6焊线式母针长针

2~4P C: E系列 1.6焊线式母针长针

8	E10 紧锁螺帽	尼龙	/	pc	1
7	E10 组装式防水硅胶塞	硅胶	/	pc	1
6	E10 插头主体	尼龙	/	pc	1
5	E10 组装式主体防水垫片 $\phi 12 \times \phi 9.3-2$	橡胶	/	pc	1
4	E系列 焊线式母针长针	黄铜	镀金	pc	1
3	E10 孔型插头外壳	尼龙	/	pc	1
2	E10 插头胶芯O型防水圈 $\phi 12 \times \phi 9 \times 1.5$	橡胶	/	pc	2~12
1	E10 螺纹式连接螺帽	尼龙	/	pc	1
No.	Specification	Material	Treat	Unit	Q'ty

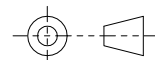
GENERAL TOLERANCE  
(UNLESS SPECIFIED)
 $\leq 10 \pm 0.1$ 
 $< 10 \sim \leq 20 \pm 0.2$ 
 $< 20 \sim \leq 50 \pm 0.5$ 
Angle  $\pm 1^\circ$ 

THIRD ANGLE

DWN

L.L

DATE

2022.8.15

CHK

DATE

APVD

DATE

UNIT

MM

REV

A

SIZE

A4

SHEET

1 OF 1

TITLE

E10 螺纹式孔型组装式插头

PART NO

DRAWING NO

E10P-TA1-Sx