

Pitch: 1.27x1.27mm(0.05 " x0.05 ")
 Female Header Dual Rows S.M.T Type

ELETE
 Professional Connecting Solutions
 HFIDM44-T050 Series

Specifications

Current Rating: 1.0 Ampere
 Insulation Resistance: 1000MΩ Min
 Dielectric Withstanding: 300V AC
 Contact Resistance: 20mΩ Max
 Operating Temperature: -40°C to +105°C

Materials

Contact Material: Phosphor Bronze
 Insulation Material: Polyester, UL 94V-0
 LCP/NL6T

All material RoHS&Reach Compliant
 Halogen-free is available

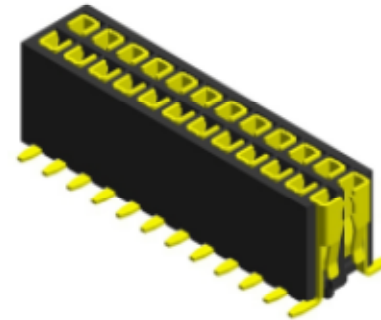

Mating with



HMIDSXX



HMIDSHXX



HMIDRXX



HMIDRHXX



HMIDMHXX

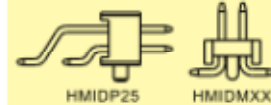
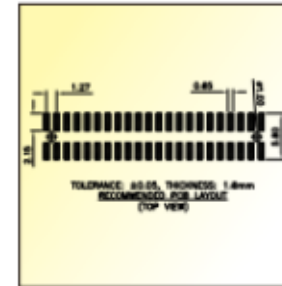
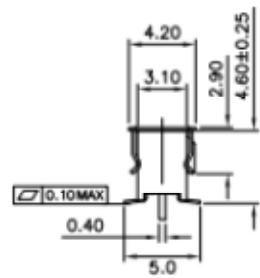
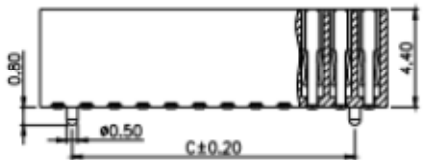
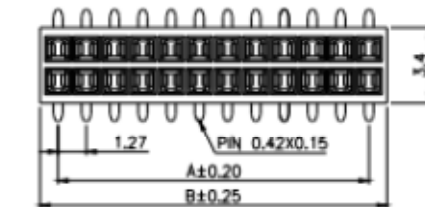

PS: Suggested Mating Pin Length: 2.8~4.0mm

No. of Pins/Row	Dimension Information			No. of Pins/Row	Dimension Information			No. of Pins/Row	Dimension Information			No. of Pins/Row	Dimension Information		
	A	B	C		A	B	C		A	B	C		A	B	C
03	2.54	4.16	1.27	13	15.24	16.86	13.97	23	27.94	29.56	26.67	33	40.64	42.26	39.37
04	3.81	5.43	2.54	14	18.51	18.13	15.24	24	29.21	30.83	27.94	34	41.91	43.53	40.64
05	5.08	6.7	3.81	15	17.78	19.4	16.51	25	30.48	32.10	29.21	35	43.18	44.80	41.91
06	6.35	7.97	5.08	16	19.05	20.67	17.78	26	31.75	33.37	30.48	36	44.45	46.07	43.18
07	7.62	9.24	6.35	17	20.32	21.94	19.05	27	33.02	34.64	31.75	37	45.72	47.34	44.45
08	8.89	10.51	7.62	18	21.59	23.21	20.32	28	34.29	35.91	33.02	38	46.99	48.61	45.72
09	10.16	11.78	8.89	19	22.86	24.48	21.59	29	35.56	37.18	34.29	39	48.26	49.88	46.99
10	11.43	13.05	10.16	20	24.13	25.75	22.86	30	36.83	38.45	35.56	40	49.53	51.15	48.26
11	12.70	14.32	11.43	21	25.40	27.02	24.13	31	38.10	39.72	36.83				
12	13.97	15.59	12.70	22	26.67	28.29	25.40	32	39.37	40.99	38.10				