



SEA Series

Features

- 85°C, 2,000 hours assured, standard miniature type with 7 ~ 9mm height for compact circuits
- RoHS Compliance



Sleeve & Marking Color: Blue & Black

Specifications

Items	Performance																													
Category Temperature Range	-40°C ~ +85°C																													
Capacitance Tolerance	±20% (at 120Hz, 20°C)																													
Leakage Current (at 20°C)	I = 0.01CV or 3 (μA) whichever is greater (after 2 minutes) Where, C = rated capacitance in μF V = rated DC working voltage in V																													
Tanδ (at 120Hz, 20°C)	<table border="1"> <tr> <th>Rated Voltage</th> <td>4</td> <td>6.3</td> <td>10</td> <td>16</td> <td>25</td> <td>35</td> <td>50</td> <td>63</td> </tr> <tr> <th>Tanδ (max)</th> <td>0.35</td> <td>0.23</td> <td>0.20</td> <td>0.16</td> <td>0.14</td> <td>0.12</td> <td>0.10</td> <td>0.10</td> </tr> </table>	Rated Voltage	4	6.3	10	16	25	35	50	63	Tanδ (max)	0.35	0.23	0.20	0.16	0.14	0.12	0.10	0.10											
Rated Voltage	4	6.3	10	16	25	35	50	63																						
Tanδ (max)	0.35	0.23	0.20	0.16	0.14	0.12	0.10	0.10																						
Low Temperature Characteristics (at 120Hz)	<p>Impedance ratio shall not exceed the values given in the table below.</p> <table border="1"> <tr> <th colspan="2">Rated Voltage</th> <td>4</td> <td>6.3</td> <td>10</td> <td>16</td> <td>25</td> <td>35</td> <td>50</td> <td>63</td> </tr> <tr> <th rowspan="2">Impedance Ratio</th> <th>Z(-25°C)/Z(+20°C)</th> <td>7</td> <td>4</td> <td>3</td> <td>3</td> <td>2</td> <td>2</td> <td>2</td> <td>2</td> </tr> <tr> <th>Z(-40°C)/Z(+20°C)</th> <td>14</td> <td>10</td> <td>8</td> <td>6</td> <td>4</td> <td>4</td> <td>4</td> <td>4</td> </tr> </table>	Rated Voltage		4	6.3	10	16	25	35	50	63	Impedance Ratio	Z(-25°C)/Z(+20°C)	7	4	3	3	2	2	2	2	Z(-40°C)/Z(+20°C)	14	10	8	6	4	4	4	4
Rated Voltage		4	6.3	10	16	25	35	50	63																					
Impedance Ratio	Z(-25°C)/Z(+20°C)	7	4	3	3	2	2	2	2																					
	Z(-40°C)/Z(+20°C)	14	10	8	6	4	4	4	4																					
Endurance	<table border="1"> <tr> <th>Test Time</th> <td>2,000 Hrs</td> </tr> <tr> <th>Capacitance Change</th> <td>Within ±20% of initial value</td> </tr> <tr> <th>Tanδ</th> <td>Less than 200% of specified value</td> </tr> <tr> <th>Leakage Current</th> <td>Within specified value</td> </tr> </table> <p>* The above specifications shall be satisfied when the capacitors are restored to 20°C after the rated voltage applied with rated ripple current for 2,000 hours at 85°C.</p>	Test Time	2,000 Hrs	Capacitance Change	Within ±20% of initial value	Tanδ	Less than 200% of specified value	Leakage Current	Within specified value																					
Test Time	2,000 Hrs																													
Capacitance Change	Within ±20% of initial value																													
Tanδ	Less than 200% of specified value																													
Leakage Current	Within specified value																													
Shelf Life Test	Test time: 500 hours; other items are the same as those for the Endurance.																													
Ripple Current & Frequency Multipliers	<table border="1"> <tr> <th rowspan="3">Cap.(μF)</th> <th colspan="6">Freq.(Hz)</th> </tr> <tr> <th>60 (50)</th> <th>120</th> <th>500</th> <th>1k</th> <th>10k up</th> <th></th> </tr> <tr> <td>Under 47</td> <td>0.70</td> <td>1.00</td> <td>1.20</td> <td>1.30</td> <td>1.45</td> </tr> <tr> <td>100 to 1,000</td> <td>0.80</td> <td>1.00</td> <td>1.10</td> <td>1.15</td> <td>1.20</td> <td></td> </tr> </table>	Cap.(μF)	Freq.(Hz)						60 (50)	120	500	1k	10k up		Under 47	0.70	1.00	1.20	1.30	1.45	100 to 1,000	0.80	1.00	1.10	1.15	1.20				
Cap.(μF)	Freq.(Hz)																													
	60 (50)		120	500	1k	10k up																								
	Under 47	0.70	1.00	1.20	1.30	1.45																								
100 to 1,000	0.80	1.00	1.10	1.15	1.20																									

Diagram of Dimensions

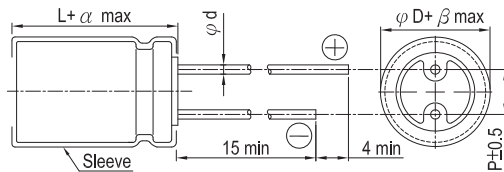

Lead Spacing and Diameter

Unit: mm

φD	4	5	6.3	8	10
P	1.5	2.0	2.5	3.5	5.0
φd	0.45	0.5		0.6	
α	1.0				
β	0.5				

Dimension & Permissible Ripple Current

Dimension: φD × L(mm)

Ripple Current: mA/rms at 120 Hz, 85°C

μF	V _{DC} Contents	4V (0G)		6.3V (0J)		10V (1A)		16V (1C)		25V (1E)		35V (1V)		50V (1H)		63V (1J)	
		φD×L	mA	φD×L	mA	φD×L	mA	φD×L	mA	φD×L	mA	φD×L	mA	φD×L	mA	φD×L	mA
1	010													4×7	10	4×7	11
2.2	2R2													4×7	15	4×7	17
3.3	3R3													4×7	18	4×7	21
4.7	4R7												4×7	22	5×7*	23	5×7*
10	100							4×7	25	4×7	26	5×7*	30	6.3×7*	34	6.3×7*	40
22	220			4×7	31	4×7	32	5×7*	39	5×7*	41	6.3×7*	47	6.3×7	53	8×7*	70
33	330	4×7	32	4×7	32	4×7	35	5×7	43	6.3×7	53	8×7*	71	8×7*	76	8×7	80
47	470	4×7	38	4×7	38	5×7*	47	6.3×7*	59	6.3×7	65	8×7*	83	8×7	85	8×7	95
100	101	5×7	61	6.3×7*	75	6.3×7	80	6.3×7	90	8×7	125	8×7	115	8×9	130	10×9	170
220	221	6.3×7	90	6.3×7	99	8×7	140	8×7	146	8×9	190	10×9	215				
330	331	8×7	129	8×7	156	8×7	165	8×9	185	10×9	265						
470	471	8×7	154	8×7	175	8×9	215	10×9	255								
1,000	102	8×9	200	10×9	205												

Note: Case size in mark of "*" is available to product down size.

Part Numbering System

SEA series	470μF	±20%	6.3V	Bulk Package	Gas Type	8 φ × 7L	Pb-free and PET sleeve
SEA	471	M	0J	BK	-	0807	
Series	Capacitance	Capacitance Tolerance	Rated Voltage	Lead Configuration & Package	Rubber Type	Case Size	Lead Wire and Sleeve type

Note: For more details, please refer to "Part Numbering System (Radial Type)" on page 11.