

ZCKY49

limit switch lever ZCKY - elastomer roller lever
Ø 50 mm variable length -

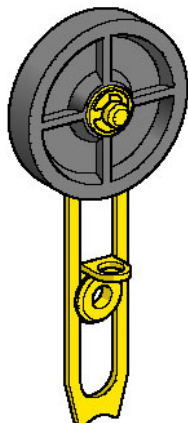

Main

Range of product	OsiSense XC
Series name	Standard format
Product or component type	Limit switch lever
Device short name	ZCKY
Product compatibility	XCKL XCKM XCKS
Associated head	ZCKD05
Type of operator	Elastomer spring return roller lever (variable length, roller diameter 50 mm)
Positive opening	Without
Environmental characteristic	Standard environment

Complementary

Movement of operating head	Rotary
Switch actuation	By 30° cam
Type of approach	Lateral approach

Environment

Ambient air temperature for operation	-25...70 °C for standard environment
Ambient air temperature for storage	-25...70 °C for standard environment
RoHS EUR conformity date	4Q2009
RoHS EUR status	Will be compliant

The information provided in this documentation contains general descriptions and/or technical characteristics of the performance of the products contained herein. This documentation is not intended as a substitute for and is not to be used for determining suitability or reliability of these products for specific user applications. It is the duty of any such user or integrator to perform the appropriate and complete risk analysis, evaluation and testing of the products with respect to the relevant specific application or use thereof. Neither Schneider Electric Industries SAS nor any of its affiliates or subsidiaries shall be responsible or liable for misuse of the information contained herein.

Mouser Electronics

Authorized Distributor

Click to View Pricing, Inventory, Delivery & Lifecycle Information:

[Schneider Electric:](#)

[ZCKY49](#)