

■产品型号 (Item No): GC2011-F

■客户图纸 (Drawing)

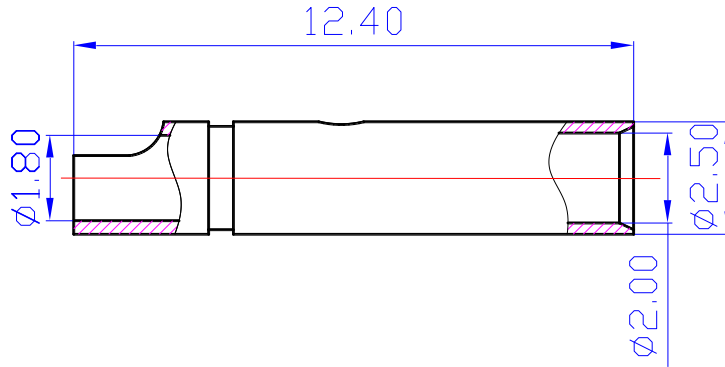

■产品材质及基本参数 (Material & Parameter)

|                        |                          |            |        |
|------------------------|--------------------------|------------|--------|
| 产品型号<br>Item No.       | GC2011-F                 | 接触电阻<br>CR | 0.80mΩ |
| 金属材质<br>Metal Material | 铜镀金<br>Brass Gold Plated | 额定电流<br>RC | 15A    |
| 推荐线规<br>Cable SPEC.    | 18AWG                    | 瞬时电流<br>MC | 30A    |
| 推荐使用次数<br>USE TIMES    | 2000 TIMES               |            |        |

★注意: 用户的使用及环境有可能与我司测试方法有出入  
(Data sheet will change according with the test background)

■产品型号 (Item No): GC2011-M

■客户图纸 (Drawing)

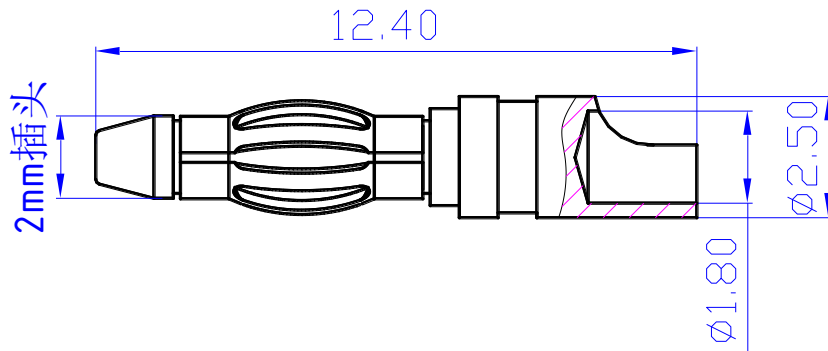

■产品材质及基本参数 (Material & Parameter)

|                        |                          |            |                |
|------------------------|--------------------------|------------|----------------|
| 产品型号<br>Item No.       | GC2011-M                 | 接触电阻<br>CR | 0.80m $\Omega$ |
| 金属材质<br>Metal Material | 铜镀金<br>Brass Gold Plated | 额定电流<br>RC | 15A            |
| 推荐线规<br>Cable SPEC.    | 18AWG                    | 瞬时电流<br>MC | 30A            |
| 推荐使用次数<br>USE TIMES    | 2000 TIMES               |            |                |

★注意: 用户的使用及环境有可能与我司测试方法有出入  
(Data sheet will change according with the test background)