

A

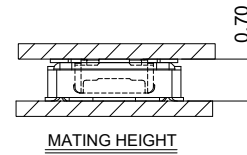

B

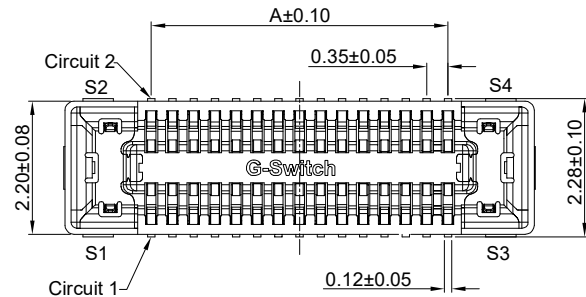
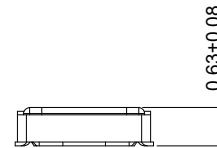
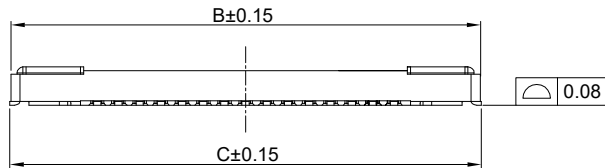

C

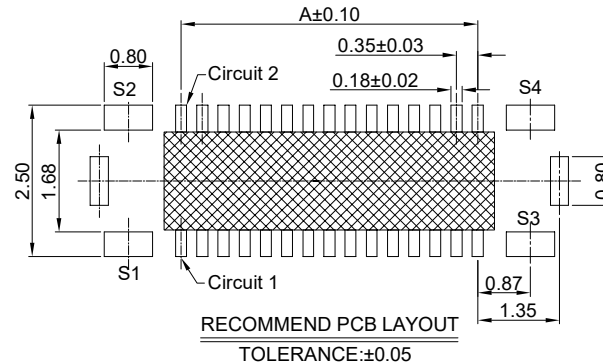
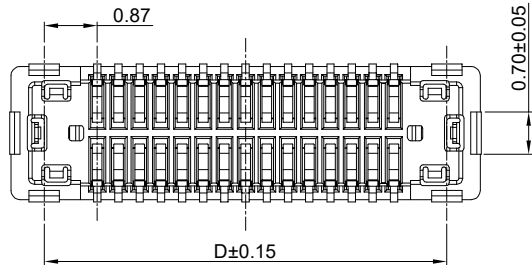

GT-B0355 F S V 06 -XX X XX 01

G-Switch  
 Series No  
 F-Female  
 Termipoint  
 S-SMT  
 ANGLE  
 V-180°  
 Terminal Plating  
 13-All Au 4U"  
 Housing Colour  
 B-Black  
 Pin Q' PY  
 10~80  
 Height  
 06-0.63mm

**G-Switch Specification:**

1. Current rated: 0.3A AC/DC. Signal pin  
Current rated: 5.0A AC/DC. Power pin
2. Voltage rating: 60V AC/DC
3. Withstanding voltage: 250V AC for 1 min
4. Contact resistance: 50mΩ max. Signal pin
5. Insulation resistance: 100MΩ min
6. Durability cycle: 30 Cycles
7. Removal force: 0.0165kgf/Pin min
8. Operating temperature range: -55°C ~ +105°C

**Ordering Information:**

Circuit	Dimensions(mm)				Circuit	Dimensions(mm)			
	A	B	C	D		A	B	C	D
10	1.40	4.25	4.29	3.15	40	6.65	9.50	9.54	8.40
16	2.45	5.30	5.34	4.20	50	8.40	11.25	11.29	10.15
20	3.15	6.00	6.04	4.90	60	10.15	13.00	13.04	11.90
24	3.85	6.70	6.74	5.60	78	13.30	16.15	16.19	15.05
30	4.90	7.75	7.79	6.65	80	13.65	16.50	16.54	15.40
34	5.60	8.45	8.49	7.35	---	---	---	---	---

E

NO.	PART NAME	NUMBER	MATERIAL	REMARK
4	SOLDER TABS+HD	2PCS	PHOSPHOR BRONZ	Contact: Au 4u"Min over Ni 50u"Min Lead: Au flash 2u"Min over Ni 50u"Min.
3	POWER PIN	S1-S4	PHOSPHOR BRONZ	Contact: Au 4u"Min over Ni 50u"Min Lead: Au flash 2u"Min over Ni 50u"Min.
2	SIGNAL PIN	PIN1 - PIN N	PHOSPHOR BRONZ	Contact: Au 4u"Min over Ni 50u"Min Lead: Au flash 2u"Min over Ni 50u"Min.
1	HOUSING	1PCS	LCP,94V-0	BLACK



SCALE: 1:1 UNIT: mm  
 SIZE: A4

Unless otherwise  
 General Tolerance:  
 X ±0.40  
 X.x ±0.30  
 X.xx ±0.20  
 X° ±5°  
 X.x° ±3°

Title: Board to Board 0.35 Pitch 180° H0.63mm  
 Dual Rows SMT Type Mate Connector

Molde Code: GT-B0355FSV06-XXXXX01

DRAWN	CHECKED	APPROVED	DATE
Hu	Chen	Chen	2022.12.28



REV: A0 SHEET: 1/1