

SECTION: A-A

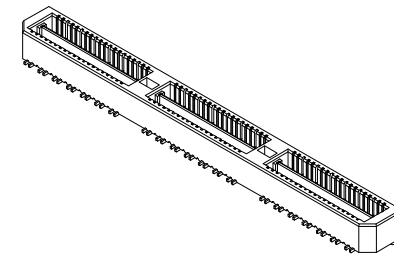

GT-B0806 M S V XX -XX X XX 02

- G-Switch**
- Series No**
- M-Male**
- Termpoint**
S-SMT
- Angle**
V-180°
- Terminal Plating**
04-Au10u"
- Housing Colour**
B-Black
- Pin Q' PY**
40-200
- Height(H1)**
01-4.267mm
02-7.264mm
03-10.269mm
04-13.269mm
05-14.269mm
06-15.246mm
07-18.240mm
08-21.237mm
09-24.237mm
10-29.238mm

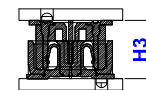
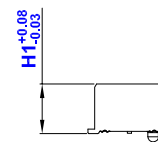
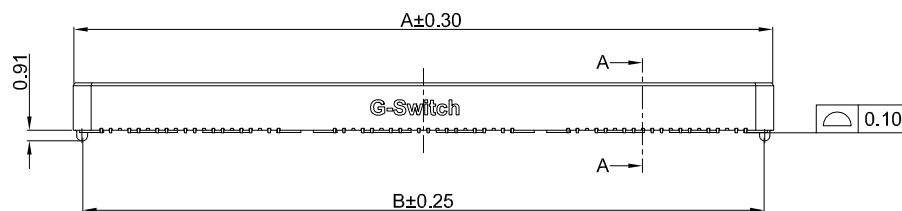

MATING HEIGHT

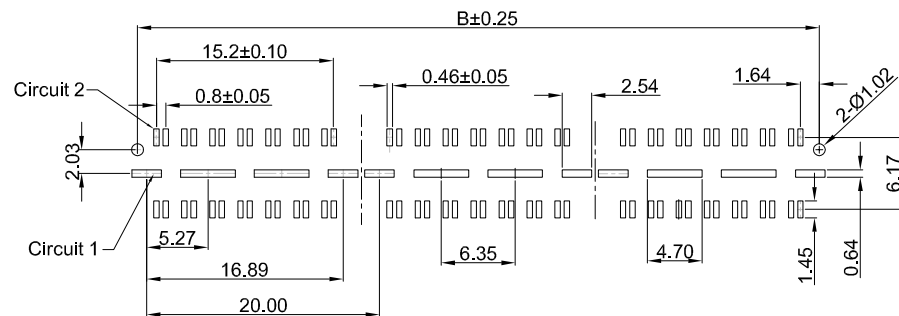
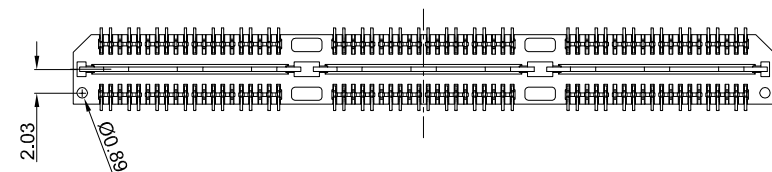

PCB REFERENCE DIAGRAM
TOLERANCE:±0.05

MATING HEIGHT(H3)	PLUG (H1,mm)	SOCKET (H2,mm)
5.00	4.265	3.25
8.00	7.264	3.25
11.00	10.269	3.25
14.00	13.269	3.25
15.00	14.269	3.25
16.00	15.246	3.25
19.00	18.240	3.25
22.00	21.237	3.25
25.00	24.237	3.25
30.00	29.238	3.25

G-Switch Specification:

- Current rated: 2.0A AC/DC
- Voltage rating: 225V AC/DC
- Withstanding voltage: 675V AC
- Contact resistance: 15mΩ Max.
- Insulation resistance: 5000MΩ min
- Durability cycle: 500 Cycles
- Removal force: 0.01kgf/Pin min
- Operating temperature range: -55°C ~ +125°C

NO.	PART NAME	MATERIAL	REMARK
2	CONTACT	PHOSPHOR BRONZE	Au10u" ON CONTACT AREA
1	HOUSING	LCP,94V-0	BLACK

Ordering Information:

Circuit	Dimensions(mm)		Circuit	Dimensions(mm)	
	A	B		A	B
28	20.00	18.48	112	80.00	78.49
56	40.00	38.48	140	100.00	98.49
84	60.00	58.48	--	--	--



SCALE: 1:1 UNIT: mm
SIZE: A4

Unless otherwise General Tolerance:
X ±0.40
X.x ±0.30
X.xx ±0.20
X° ±5°
X.x° ±3°

Title: BTB 0.80mm Pitch 180° Dual Rows SMT Type Mate Connector

Molde Code: GT-B0806MSVXX-XXXXX02

DRAWN	CHECKED	APPROVED	DATE
Hu	Hu	Chen	2022.12.28



REV: A0 SHEET: 1/1