

GT-B0806 M S V XX -XX X XX 01

**G-Switch**  
**Series No**  
**M-Male**  
**Termpoint**  
 S-SMT  
**Angle**  
 V-180°

**Terminal Plating**  
 04-Au10u"  
**Housing Colour**  
 B-Black  
**Pin Q' PY**  
 40-200  
**Height(H1)**  
 01-4.267mm  
 02-7.264mm  
 03-10.269mm  
 04-13.269mm  
 05-14.269mm  
 06-15.246mm  
 07-18.240mm  
 08-21.237mm  
 09-24.237mm  
 10-29.238mm

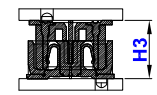
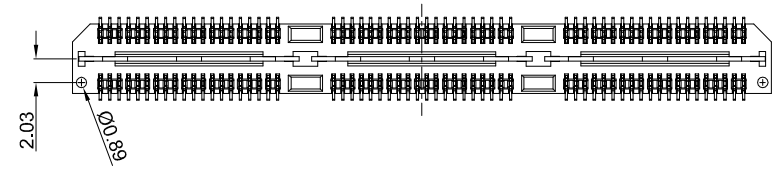

MATING HEIGHT

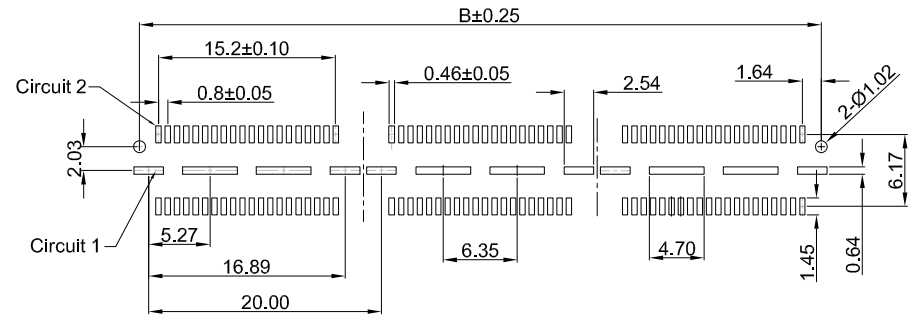

PCB REFERENCE DIAGRAM  
 TOLERANCE:±0.05

MATING HEIGHT(H3)	PLUG (H1,mm)	SOCKET (H2,mm)
5.00	4.265	3.25
8.00	7.264	3.25
11.00	10.269	3.25
14.00	13.269	3.25
15.00	14.269	3.25
16.00	15.246	3.25
19.00	18.240	3.25
22.00	21.237	3.25
25.00	24.237	3.25
30.00	29.238	3.25

**G-Switch Specification:**

- 1.Current rated: 2.0A AC/DC
- 2.Voltage rating: 225V AC/DC
- 3.Withstanding voltage: 675V AC
- 4.Contact resistance: 15mΩ Max.
- 5.Insulation resistance: 5000MΩ min
- 6.Durability cycle: 500 Cycles
- 7.Removal force: 0.01kgf/Pin min
- 8.Operating temperature range: -55°C ~ +125°C

NO.	PART NAME	MATERIAL	REMARK
2	CONTACT	PHOSPHOR BRONZE	Au10u" ON CONTACT AREA
1	HOUSING	LCP,94V-0	BLACK

**Ordering Information:**

Circuit	Dimensions(mm)		Circuit	Dimensions(mm)	
	A	B		A	B
40	20.00	18.48	160	80.00	78.49
80	40.00	38.48	200	100.00	98.49
120	60.00	58.48	--	--	--



SCALE: 1:1 UNIT: mm  
 SIZE: A4

Title: BTB 0.80mm Pitch 180° Dual Rows SMT Type Mate Connector

Unless otherwise General Tolerance:  
 X ±0.40  
 X.x ±0.30  
 X.xx ±0.20  
 X° ±5°  
 X.x° ±3°

Molde Code: GT-B0806MSVXX-XXXXX01

DRAWN	CHECKED	APPROVED	DATE
Hu	Hu	Chen	2022.12.28



REV: A0 SHEET: 1/1