

REVISIONS					
REV.	ECN NO.	LOCATION	DESCRIPTION	DATE	DESIGN
A0	N/A		INITIAL RELEASE	/	/
A1	N/A		图面升级整理图面	2025.2.26	阿树

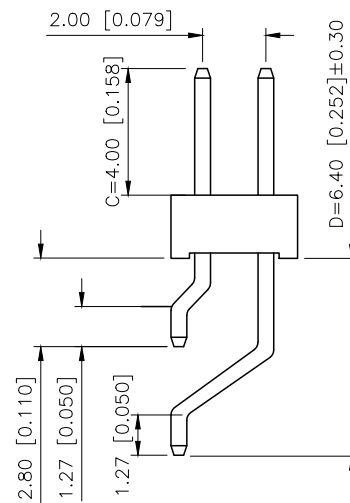
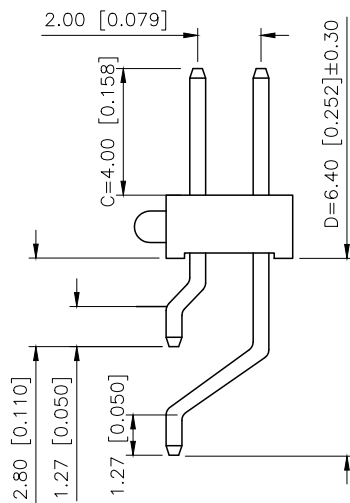
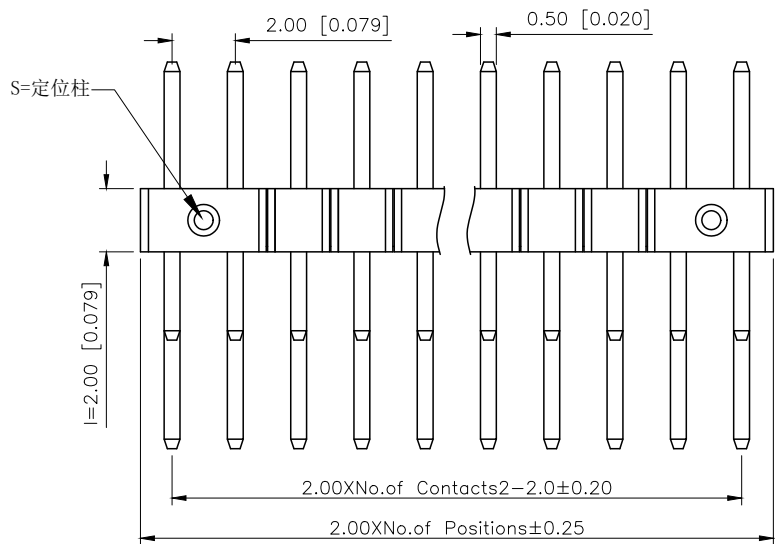
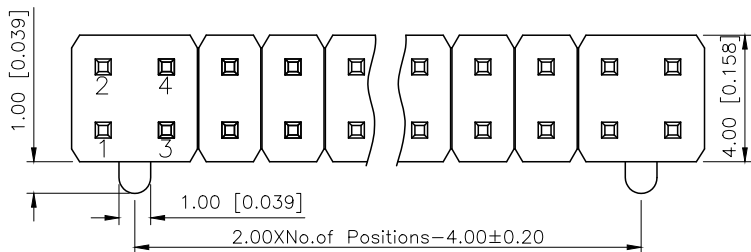

X4621WRS-2xXXIS-C40D64

X4621WRS-2xXXI-C40D64

Specifications:  
规格:  
Voltage rating:250V AC/DC  
额定电压: 250V AC/DC  
Current rating:2A AC/DC  
额定电流: 2A AC/DC  
Withstanding voltage:500V AC/minute  
耐受电压: 500V AC/分钟  
Temperature range:-40°C-+105°C  
温度范围: -40°C-+105°C  
Insulation resistance:1000MΩ min  
绝缘电阻: 1000MΩ Min  
Contact resistance:20MΩ Max  
接触电阻: 20MΩ Max  
Plating Category:1U'' Gold  
镀层:1U'' Gold  
Reflow soldering temperature:260±5°C, 10S  
回流焊温度: 260±5°C, 10S

PART NO.:

X4621 W R S-2xXX I S-C40 D64  
① ② ③ ④ ⑤ ⑥ ⑦ ⑧ ⑨

- ①Series No
- ②Category:W-Wafer
- ③Welding Board Angle:R-Stright 90°
- ④Welding Way:S-SMT
- ⑤Row No.Pin No:2xXX Pin
- ⑥Plastic Height:l=2.0mm
- ⑦Category:S-With positioning column
- ⑧Pin length:C=4.0mm
- ⑨Pin length:D=6.4mm

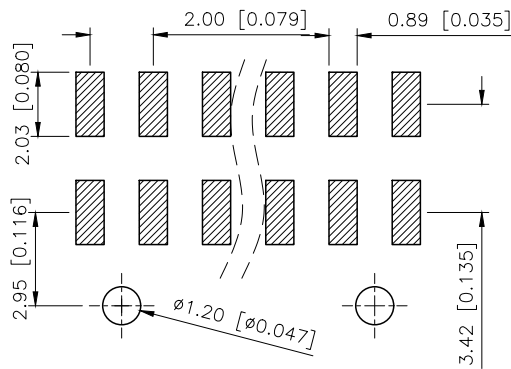

P.C.B LAYOUT

X4621WRS-2xXXI-C40D64	PA6T	Brass	X4621F
X4621WRS-2xXXIS-C40D64			
PART NO	Material	Material(Pin)	Suitable XKB Female

AuGLAR	±5°
X.	±0.40
X.x	±0.30
X.xx	±0.20
X.xxx	±0.15
UNSPECIFIED TOLERANCES	



DESIGN	阿树	VIEW:	MODEL TYPE: 2.0mm BTB Connector
CHECKED		UNIT: mm/in	PART NO.: X4621WRS-2xXXIS-C40D64
APPROVED		SIZE: A4	DWG NO.: